

## K-OBR 260 Forward Curved Single Inlet Centrifugal Fan

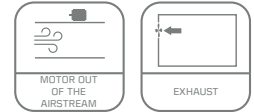

K-OBR 260 fans motor out of air flow, it can be used as an ideal solution for the transfer of air at high temperatures or as a component part of the machines in multi-purpose drying, cooling, heating processes or commercial kitchen hood ventilation applications. It can be used for packaging, plastic injection, ironing machines, greenhouses, restaurant hood ventilation etc.



MOTOR INSULATION CLASS	F CLASS
MOTOR PROTECTION CLASS	IP 55
MOTOR EFFICIENCY CLASS	IE1-IE2
MOTOR ENCLOSURE TYPE	TEFC
MOTOR BRAND	KALVENT
BODY MATERIAL	SHEET METAL
BODY COATING	ELECTROSTATIC POWDER PAINT
IMPELLER MATERIAL	GALVANIZED SHEET METAL
DUTY CYCLE	IEC Duty Cycle-S1
WORKING AMBIENT TEMPERATURE	-20 +50 °C
DIRECTIVE	IEC-60335-2-80, ISO 1940-1

MODEL	VOLTAGE (V)	FREQUENCY (Hz)	POWER (KW)	REVOLUTION (rpm)	FLOW RATE (m³/h)	NOISE LEVEL (dB(A))	PRICE
K-OBR 260M 2K	230	50	0,75	2.770	2.700	70	
K-OBR 260M 4K	230	50	0,25	1450	1.450	64	
K-OBR 260T 2K	380	50	0,75	2.700	2.700	70	
K-OBR 260T 4K	380	50	0,25	1.450	1.450	64	
K-OBRS 260M 2K	230	50	0,75	2.700	2.820	74	
K-OBRS 260M 4K	230	50	0,25	1.450	1.380	61	

Values are for 0 Pa.

## DRAWING

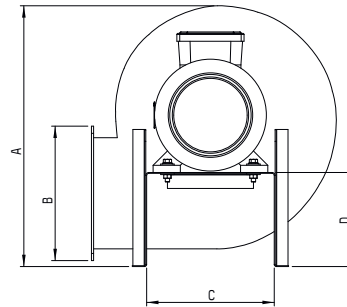
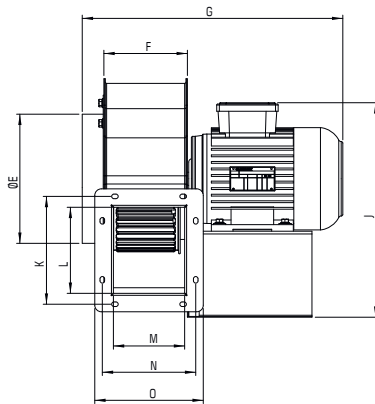

MODEL	A (mm)	B (mm)	C (mm)	D (mm)	E (mm)	F (mm)	G (mm)	J (mm)	K (mm)	L (mm)	M (mm)	N (mm)	O (mm)
K-OBR 260	361	194	155	119	197	128	405	327	162	137	115	140	163

# PERFORMANCE CURVES

K-OBR 260 2K

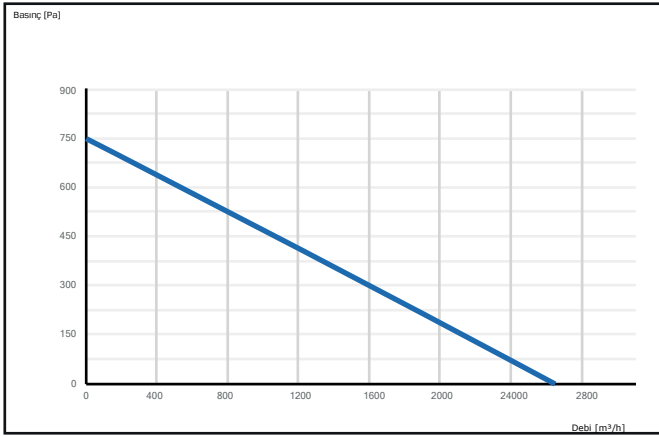

K-OBR 260 4K

